

2023-24

# Vancouver Island University

Graduate Programs





# Nanaimo, British Columbia

Vancouver Island University is a public university located on the magnificent west coast of Canada. Our inspiring natural setting, personal attention in small size classes, quality programming and values-based education, together, set VIU apart from other universities. In this nurturing environment we celebrate students' academic accomplishments as much as we celebrate their social competencies. We aim to help students develop their relationship skills by engaging with local and global communities within and beyond the classroom.



# Our Campus

## Vancouver Island University Facts



**12,000**  
Students



Maximum class size of  
**34**  
Students



**120+**  
Programs



**1,400+**  
international students



**89**  
Countries



**9**  
Faculties

**Our campus is centrally located in downtown Nanaimo.**  
**Our students enjoy close proximity to:**

Public Transit | Aquatic + Ice Centre  
Shopping | Museums | Restaurants

**Our facilities include:**

Gymnasium | Cafeterias | Library  
Student Lounges | Medical Clinic  
Bookstore | Student Residence

## Did you Know?

### Nanaimo Facts



Population of  
**100,000**



**2nd**  
Largest city on Vancouver Island

**1**  
Airport with connections  
to Vancouver, Toronto,  
and Calgary

The safety of our students, staff and community is always our first priority.  
For the latest updates and more information on VIU's response to COVID-19, please visit:  
[world.viu.ca/covid-19-updates-international-students](https://world.viu.ca/covid-19-updates-international-students)



Graduate Programs  viu.ca for details	Credential	Master's Degree 2 years	Graduate Diploma 1 year	Graduate Diploma 2 year	Graduate Certificate 1 year	Post-Degree Diploma 1 year	Intake		Apply by	GPA (calculated in last 2 yrs)	Letter of intent	Work Experience	References	Resume	Bachelor's Degree	ESL Available	Assessment Form	Notes
							September	January										
Business Administration (MBA)	✓						✓	✓	March 31 June 30	B*	✓	✓	2	✓	✓	✓		No GMAT; internship
Sustainable Leisure Management	✓					✓	✓		March 31	B*	✓		3	✓	✓	✓	3	
Community Planning	✓						✓		Feb 28	B*	✓		3	✓	✓			
Geographic Information Systems	✓					✓	✓		Jan 31	B*	✓	✓	2	✓	✓	✓		Intro GIS course; Practicum
Educational Leadership	✓						✓		March 31	B*	✓	✓	2	✓	✓	✓	2	2 years of teaching experience preferred
Special Education	✓						✓		March 31	B*	✓	✓	2	✓	✓	✓	2	2 years of teaching experience preferred
Online Educational Leadership (Montessori option)					✓		✓		March 31	B*	✓	✓	2	✓	✓		✓	2 years of teaching experience preferred. Can ladder into the Master of Educational Leadership
Business (GCIB)					✓		✓	✓	March 31 June 30	C+					✓	✓		Can ladder into GDPM, GDIT and MBA programs
Project Management (GDPM)			✓				✓		March 31 June 30	C+		✓		✓	✓	✓		Business degree + 1 year work experience, or completion of GCIB
Fisheries and Aquaculture						✓	✓		March 31	B					✓	✓		Bachelor of Science; interview; permission of department
Online Learning and Teaching			✓				✓		August 15	B*								Can ladder into the Master of Educational Leadership

\* Under review

# Master of Business Administration (MBA)



The MBA program at Vancouver Island University (VIU) is a full-time, cohort based program that builds the managerial competence to navigate and meet the challenges of an increasingly complex, digital, interconnected world. With a focus on building the leaders of tomorrow, the VIU MBA program is one of the most technologically integrated programs in Canada, with data analytics embedded in research courses and four dedicated, technology-focused courses. MBA students are supported by career coaching throughout the program, and work with industry mentors during an internship where they undertake an applied business project.

## Application Period

October 1 – March 31

*September start*

First business day in

January to June 30

*January start*

## Program Length

20 months

## Full Program Tuition

\$49,950 (CAD) for 2 years

## Features

Integrated business internship

Two start dates per year

No GMAT required

Any bachelor degree accepted

90% of graduates are working full-time in 4-8 months

## Career Possibilities

Management

Business Development

Corporate Finance

Account Management

Consulting: Strategy, Operations or Human Resources

Sales and Marketing

Entrepreneur

## Admission Requirements

- Bachelor's degree with a minimum "B" average in the last two years of undergraduate degree.
- Letter of introduction explaining how the MBA will contribute to career plans.
- A résumé describing education, work and volunteer experience.
- Two letters of recommendation from past employers or professors.
- One year minimum of work experience.
- No GMAT (entrance examination) score.
- Meet one of the following VIU English language requirements:
  - IELTS 7.0 with no band below 6.5;
  - TOEFL iBT 93 with no band below 20; or
  - Completion of VIU's English Language Grad Prep program.

*Note: Applicants without a Bachelor degree, but with significant work experience, may apply with a GMAT score. These applicants will be considered on an individual basis.*

## Ethan Xiong, China

The variety of business knowledge and abilities I gained during this program will enable me to adapt more quickly in my future work. The small class size is significant for students; it makes it easy to speak with professors.

The factors that I enjoyed most about the program at VIU are the professor's teaching style, good classmates, convenient facilities and the various events that take place around the campus. And Nanaimo is a really wonderful place for students to focus on studies.



## Admission Requirements

- Bachelor's degree.
- A minimum average of "B" calculated in the last two years of the undergraduate degree.
- Résumé.
- Three letters of reference and three referee forms (preferably two academic referees and one professional).
- Statement of interest addressing each of the following:
  - Areas of research interest (i.e. parks, festivals, resorts, tourism, etc.);
  - Statement of career interest; and
  - Summary of relevant preparation (i.e. career and academic).
- Interview (if requested).
- Meet one of the following VIU English language requirements:
  - IELTS 7.0 with no band below 6.5;
  - TOEFL iBT 93 with no band below 20; or
  - Completion of VIU's English Language Grad Prep program.

# Master of Arts in Sustainable Leisure Management (MASLM)

The MASLM is a full-time, cohort based program that equips leaders with the knowledge and skills to apply innovative solutions in the global context. The program begins with eight months of course work, including: principles and paradigms of leisure and sustainability, influencing change, knowledge creation and mobilization and case studies in sustainability. In the second year, students are mentored individually as they apply their knowledge and skills to a field experience, and document their results in a research thesis. This world-class program prepares students to address sustainability challenges and create solutions that ensure all stakeholders can enjoy natural and cultural resources.

### Application Period

October 1-March 31

*September start*

### Program Length

2 years

### Full Program Tuition

\$26,850 (CAD) for 2 years

### Features

2-year program

12 months of fieldwork and thesis research

Strong ties to industry

VIU is designated as a World Leisure Centre of Excellence with the World Leisure Organization

8-month residency requirement

### Career Possibilities

Sustainability Analyst

Eco-Tourism Consultant

University Researcher

Community Development Officer

Tourism Development Manager

Tourism Entrepreneur



### Brighton, Tanzania

It was not easy to move from my home country to Canada but I have not regretted it. VIU has become my second home. A place where I can be me.



## Lihui Wu

*Master of Arts in Sustainable Leisure Management*

Instructors in the courses are experts in specific fields of study in leisure. They offer professional guidance to students. They promoted critical thinking and independent learning. They offer students freedom to explore fields of study they are interested in. The learning atmosphere is relaxing and encouraging.

In the program we learn advanced theories such as United Nations Sustainable Development Goals (UN SDGs) and also had the opportunity to put these theories into practice.

I was lucky to be able to join the cohort's field experiences. I learned how public or private businesses promote innovations and achieve social, environmental, and economic sustainability. These experiences were like adventures, helping me not only gain professional knowledge but also learn local cultures.

Students in the cohort were from different parts of the world. The diversity of students promoted cross-cultural communication and provided great opportunities to learn different cultures and understand different ways of behavior.

Nanaimo is a wonderful place to live with unique features. There are a variety of recreational and leisure opportunities, such as hiking, whale-watching, Kayaking, golfing, fishing, diving, etc.



## Admission Requirements

- Bachelor's degree.
- Significant previous experience or training in GIS including completion of an introductory GIS course from an accredited post-secondary institution.
- A letter of intent that includes:
  - a summary of academic and professional experience;
  - a statement of career goals; and
  - a description of the research topic which the applicant wishes to pursue.
- Two letters of reference.
- Interview (if requested).
- Meet one of the following VIU English language requirements:
  - IELTS 7.0 with no band below 6.5;
  - TOEFL iBT 93 with no band below 20; or
  - Completion of VIU's English Language Grad Prep program.

# Master of GIS Applications

The Master of Geographic Information Systems Applications (MGISA) program is designed for students who have completed some GIS studies and want to prepare for work in GIS management and consulting. In addition to courses in advanced GIS techniques and management students will complete a substantial research project under faculty supervision in consultation with an industry partner.

### Application Period

October 1 – January 31

*September start*

### Program Length

2 years

### Full Program Tuition

\$37,500 (CAD) for 2 years

### Features

2 year program with 2 month practicum included

Strong ties to industry, government and non-governmental organizations

### Career Possibilities

GIS Administration

Research

Teaching

GIS Consulting

GIS Systems Design

GIS Applications Programming

### Shri, India

The course had a lot of content to cover. The first semester was time consuming with assignments and short quizzes. Every single day was completely packed with assignments and submissions but I could manage it with ease. All in all, I am completely satisfied with the course.



# Master of Education in Educational Leadership

The Master of Education (MEd) in Educational Leadership (MEDL) is a program of professional preparation for aspiring and practicing school leaders. Grounded in rich educational leadership literature supplemented by extensive faculty expertise and experience, the program provides a balance of research, policy and practice. Join a select group of international and Canadian students at scenic Vancouver Island University in a program that will prepare you for leadership roles.

## Application Period

October 1-Feb 28

*September start*

## Program Length

2 years

## Full Program Tuition

\$26,850 (CAD) for 2 years

## Features

2-year full-time, cohort-based program

Directed project or thesis completed in year 2

Strong focus on developing leadership knowledge and skills for the field of education

Rich program grounded in educational transformation

Internationalized curriculum and perspective

## Career Possibilities

Independent School Teacher/Leader

College Instructor and/or Leader

International Education Professional

Industry Training

Education Researcher

## Admission Requirements

- Bachelor's degree (Bachelor of Education preferred) with a minimum average of "B" in the last two years.
- A résumé outlining teaching experience (two years preferred).
- Two current, confidential assessment reports.
- A letter of intent explaining why the applicant wishes to pursue graduate work in this area.
- Meet one of the following VIU English language requirements:
  - IELTS 7.0 with no band below 6.5;
  - TOEFL iBT 93 with no band below 20; or
  - Completion of VIU's English Language Grad Prep program.
- Flexible admission can be available when there is significant professional experience relevant to the proposed area of scholarship.

## Kirandeep, India

As a VIU student, I was able to explore myself. People explore new cultures, places and many other things but I got a chance to know myself, which I believe is more important for success.



## Admission Requirements

- Bachelor's degree with a minimum average of "B" in the last two years.
- A résumé outlining teaching experience (two years preferred).
- Two current, confidential assessment reports.
- A letter of intent explaining why the applicant wishes to pursue graduate work in this area.
- Meet one of the following VIU English language requirements:
  - IELTS 7.0 with no band below 6.5;
  - TOEFL iBT 93 with no band below 20; or
  - Completion of VIU's English Language Grad Prep program.
- Flexible admission can be available when there is significant professional experience relevant to the proposed area of scholarship.

# Master of Education in Special Education

VIU's Master of Education (MEd) in Special Education (MEDS) embodies an innovative approach to working with students who have special needs (e.g. learning, developmental, behavioural, or physical needs). Grounded in research and evidence-based practices, our program challenges students to critically examine historical and contemporary special education policies and approaches to formulate a best practice. Faculty bring their extensive experiences to maximize student learning in each part of the program.

### Application Period

October 1-March 31

*September start*

### Program Length

2 years

### Full Program Tuition

\$26,850 (CAD) for 2 years

### Features

2-year full-time, cohort-based program

Directed project or thesis completed in year 2

Responsive teaching

Principles of assessment and intervention planning

Examination of critical issues and evidence-based pedagogies

### Career Possibilities

Independent School Special Education Teacher

College Instructor

Special Education Consultant

Disabilities Advisor

Industry Training

Education Researcher

### Margaux Cadenas, Philippines

I have learned so many new things about the field of Special Education and thanks to my wonderful instructors and cohort, I am even more motivated to do what I can to influence the life of a child with unique abilities. VIU appeared to be a place that someone could call home and it turned out to be exactly that place for me.



# Master of Community Planning

Planning is a growing profession and this master's degree opens doors to many opportunities within the field. Professional planners work for all levels of government, not-for-profit agencies and consulting firms to advance the public good and improve the quality of community life for citizens around the world. Our Master of Community Planning (MCP) combines research, applied learning and interactions with the professional planning community to assist students in gaining the skills, abilities and knowledge necessary to establish or advance a successful career as a community planner.

## Application Period

October 1-February 28

*September start*

## Program Length

2 years

## Full Program Tuition

\$26,850 (CAD) for 2 years

## Features

2-year program

Small city and town planning

Community and urban design

First Nations planning with attention to the issues relevant to the First Nations of Vancouver Island and coastal BC

Sustainable economic issues including tourism

## Career Possibilities

Land Use Planner

Project Manager

Researcher

Urban Designer

City Manager

Land Professional

## Admission Requirements

- Bachelor's degree with a minimum average of "B" calculated in the last two years of the undergraduate degree.
- Résumé.
- Three letters of reference (academic or professional referees). These may be submitted as either a Letter of Reference or a completed Assessment Form (available online).
- Statement of interest addressing each of the following areas:
  - Areas of research interest;
  - Statement of career interest; and
  - Statement of volunteer and/or career experience.
- Meet one of the following VIU English language requirements:
  - IELTS 7.0 with no band below 6.5;
  - TOEFL iBT 93 with no band below 20.

## Sonal, India

As an international student, I was new to western education systems and would have been lost in a big pool of students. A small cohort presented many opportunities to develop my skills and build my network.



## Admission Requirements

- An undergraduate or master's degree in business from a recognised university with a minimum "C+" (2.33) grade point average on the most recent 60 credits, or VIU's Graduate Certificate in Business (GCIB) with a minimum "C+" (2.33) grade point average.
- Meet one of the following VIU English language requirements:
  - IELTS 7.0 with no band below 6.5;
  - TOEFL iBT 93 with no band below 20; or
  - Completion of VIU's English Language Grad Prep program.
- Preference will be given to individuals whose background, and prior work and study indicate preparation for careers in project management.

# Graduate Diploma in Project Management (GDPM)

The GDPM is a full-time one-year cohort based program that builds specialized expertise in the tools and techniques of project management. GDPM equips students with the critical knowledge and skills for effectively managing medium/large scale projects, including: project scoping and scheduling, cost and time control, risk assessment, project implementation, monitoring and control systems. Successful GDPM students are eligible to complete assessment for the Certified Associate Project Management (CAPM) and Project Management Professional (PMP) designations of the Project Management Institute (PMI). The program has one intake that starts in the fall and is delivered over three semesters.

### Application Period

October 1 – March 31

*September start*

### Program Length

1 year (3 semesters)

### Program Tuition

\$22,350 (CAD) for 1 year

### Features

Specialized project management knowledge and skills

Cohort based program

Preparation for CAPM and PMP designations

Integrated project management applied project

One year membership in the Canadian Project Management Institute

### Career Possibilities

Business Project Manager

Development Project Manager

Operations Project Manager

Site Manager



### Ezinne Chinenye Emmanuel – Graduate Diploma in Project Management

I have and I am still having wonderful experiences each day. My professors are wonderful and willing to teach and listen. My co-students are always willing to assist. I had culture shock initially, but was able to adapt quickly because of their help and direction.



## Edward Tumaneng

*Graduate Diploma in Project Management*

Based on my research, this is where Vancouver Island University in Canada sets itself apart from other universities. VIU is known for its value- and socio-cultural based program that is closely integrated to the environment and the First Nations Ways of Knowing. This, for me, is an invaluable addition to my education and professional development.

I was mesmerized when I visited the campus for the first time because there is so much of mother nature around – trees, snow-capped mountains, lakes, rivers, and vast open fields and it made me excited more about going to the university!

The overall pace of the classes is manageable and as with any post-secondary level of education, there is a significant amount of reading, analysis, and group work, but none of these are extremely overwhelming. The professors have exhibited their expertise with all of them having solid experiences in professional project management and that adds a lot of substance and credibility on the teachings and the discussions

I believe that an internationally recognized education like VIU is always a plus on one's professional profile. Canada is known to have an excellent health care infrastructure, so studying in a Canadian-based university will be complementary to my career as a Project Manager in healthcare systems.



## Admission Requirements

- An undergraduate degree from a recognized institution or Red Seal Endorsement.
- Meet one of the following VIU English language requirements:
  - IELTS 7.0 with no band below 6.5;
  - TOEFL iBT 93 with no band below 20; or
  - Completion of VIU's English Language Grad Prep program.
- Preference will be given to candidates with at least one year of work experience.
- Graduates of the certificate program with a CGPA of 3.0 or higher and one year of work experience may apply for direct entry into the MBA program.
- Graduates with a CGPA of 2.33 can apply for direct entry into the Graduate Diploma in Project Management.

# Graduate Certificate in Business (GCIB)

The GCIB is a full-time, cohort based program that builds foundational business knowledge and skills. GCIB equips students with critical concepts in strategy, leadership, accounting, and finance. The program is delivered over three semesters and has two intakes: September and January. GCIB is designed for students looking to build business knowledge and/or for those needing a business credential before continuing on to one of the VIU Faculty of Management graduate diplomas or the MBA.

### Application Period

October 1 – March 31

*September start*

First business day in

January to June 30

*January start*

### Program Length

1 year (3 semesters)

### Program Tuition

\$22,350 (CAD) for 1 year

### Features

Gain core business knowledge and skill

Build academic skills required for success at the graduate level

Cohort based program

Two start dates per year

Admission with any bachelor degree or Red Seal certification

### Career Possibilities

Administrative Officer

Human Resources Specialist

Marketing Coordinator



### Carolane Rheault, Canada

The Graduate Certificate was a perfect opportunity to get a solid footing in the business and management world without the intense commitment of an MBA program. The location of the program was a bonus; I'd get to explore beautiful Vancouver Island and appreciate the incredible sights the Island has to offer.



LEARN ENGLISH at a university recognized for teaching excellence

Program	Description	Length	Dates (2023)	Tuition
Language Foundations (levels 1-3)	An English language program focusing on reading, writing, listening and speaking skills. Students can enter ESL university preparation course upon successful completion of Level 3. * Listening & Speaking - 7 weeks, Reading & Writing - 7 weeks	7 week and 14,5 weeks	Jan 9 - Feb 24 Mar 2 - Apr 19 Jan 9 - Apr 19 (14,5 weeks)  May 3 - June 20 June 26 - Aug 11 May 15 - Aug 23 (14,5 weeks)	\$2,660 and \$5,310
University Preparation (levels 4 & 5)	Academic preparation for students who want to study in a Canadian university. Students can enter undergraduate credit studies after successful completion of level 5. * Listening & Speaking - 7 weeks, Reading & Writing - 7 weeks	7 week and 14,5 weeks	Sept 5 - Oct 20 Oct 26 - Dec 13 Sept 5 - Dec 13 (14,5 weeks)	\$2,600 and \$5,310
Graduate Preparation	Academic preparation for students who want to study a master's degree at VIU. Students can enter graduate studies after successful completion of Grad Prep.	14,5 weeks	Jan 5 - Apr 12 Apr 17 - Aug 2 Sept 7 - Dec 13	\$5,310
TESL certificate**	A TESL Canada accredited certificate in Teaching English as a Second or Foreign Language (TESL) with 100 hours of theory plus a 20-hour supervised practicum.			\$2,600

\* Students must finish two terms to complete a level

\*\* Currently under review

In order to assign a student to the appropriate course level, an English Placement Test (EPT) must be submitted with the application to VIU.



Direct entry scores to ESL courses		Sample budget for one ESL semester (13 weeks)	
IELTS or equivalent test requirement	Level of direct entry	Application Fee	\$150
IELTS 4.0 (no band lower than 3.5)	Language Foundation 1	Tuition	\$5,310
IELTS 4.5 (no band lower than 4.0)	Language Foundation 2	Ancillary Fee	\$304
IELTS 5.0 (no band lower than 4.5)	Language Foundation 3	Student Union Fee	\$99.52
IELTS 5.5 (no band lower than 5.0)	University Preparation 4	Medical Insurance	\$246
IELTS 6.0 (no band lower than 5.5)	University Preparation 5	Homestay Registration Fee	\$275
IELTS 6.5 (no band lower than 6.0)	Grad Prep	Homestay Fee (\$1050/month)	\$4,200
		<b>Total</b>	<b>\$10,584.52</b>

Prices are in Canadian dollars, and are subject to change without notice.

# Study, Work, and Live in Canada

## Study in Canada\*

*\*English language courses can be taken prior to the start of academic program.*

### Undergraduate programs

- 1-year Certificate
- 2-year Diplomas
- 4-year Bachelor's degrees

### Postgraduate programs

- 1-year Graduate Certificates and Diplomas
- 2-year Graduate Diplomas
- 2-year Master's degrees



## Work in Canada\*

*\*Multiple conditions apply. Work eligibility and requirements may change with limited or no notice.*

### On campus

- Can work any amount of hours during semester and scheduled (study) breaks
- Can work on or off campus if your study permits lists a condition that says "you're allowed to work on- or off-campus."
- Have a Social Insurance Number (SIN)

### Off campus

- 20 hours per week during semesters and full-time during study breaks
- Can work on or off campus if your study permit lists a condition that says "you're allowed to work on-or off-campus"
- Program must be at least 6 months long
- Have valid study permit, be a full-time student

### Co-op or intern

- Work permit required
- The intended employment must be an essential part of the academic program but not exceeding 50% of it

### Post-graduation

- Post-Graduation Work Permit (PGWP) required
- Graduation from VIU or other eligible DLI
- Length of PGWP ranges 8 months - 3 years

## Live in Canada\*

*\*Multiple conditions apply. Work eligibility and requirements may change with limited or no notice.*

### Federal programs

- Federal Skilled Worker
- Federal Skilled Trades program
- Canadian Experience Class
- Start-up Visa
- Self-employed persons

### Provincial programs (British Columbia)

- Skilled Worker
- Health Care Professional
- International Graduate
- International Post-Graduate
- Entry Level and Semi-Skilled Worker
- Tech Pilot
- Strategic Projects
- Entrepreneur
- Entrepreneur Regional Pilot



# Work

## Who hires our graduates?

Many of our international graduates have successfully found jobs in their area of study. Here are some of the many companies that hire VIU graduates in Canada and globally.

All major banks in Canada

Apple

Audi

BASF

B&I

Rogers

BMW MINI

Cambridge Medical Rehabilitation

Chevron

Deloitte Canada

Disneyland

ElringKlinger

Government of BC

Hootsuite

Imperial Oil

Kellogg Company

KPMG

Moneris

PwC



# Housing: The Right Fit for You

Your Canadian experience may vary significantly depending on the accommodation option you choose. It is up to you to decide which arrangement is more suitable for you or you can try them all throughout the term of your program.

Meal plans and/or gift cards can be purchased in advance.

View details at [services.viu.ca/food-services/meal-plans](https://services.viu.ca/food-services/meal-plans)

**Note:** Fees are subject to change. Please check [world.viu.ca/cost-calculator](https://world.viu.ca/cost-calculator) for updates.

## Homestay

Provided by Canada

Homestay Network

Fees available on request

A Canadian family experience

Practice everyday English  
language skills

Off-campus

Trained host families

24-hour emergency support

### Apply:

Minimum 6 weeks before move-in day  
[world.viu.ca/homestay](https://world.viu.ca/homestay)

### Contact:

[studentinfo@canadahomestaynetwork.ca](mailto:studentinfo@canadahomestaynetwork.ca)

## Residence

\$550 double room

\$925 - \$987.50 single room

Damage deposit required by landlord

(Additional fees between terms)

Semi-Independent living

Live on campus with Canadian  
and international students

Mentorship, support and social events

24-hour staff on site

\$500 Room Deposit

### Apply:

By May 1 for 1st year guarantee  
[viu.ca/residence](https://viu.ca/residence)

Contact: [residence@viu.ca](mailto:residence@viu.ca)

## Off-campus Housing

From \$600/room

\$1,200-\$1,600/apartment

Damage deposit required by landlord

(rental rates vary)

Options for roommates, families and students  
with couples

Flexibility of choice: apartment, house etc)

Independent living with landlord  
and/or roommates

Self-directed search with ongoing support  
from off-campus housing

Contact: [ie.housing@viu.ca](mailto:ie.housing@viu.ca)

## VIU Residence Room Layouts

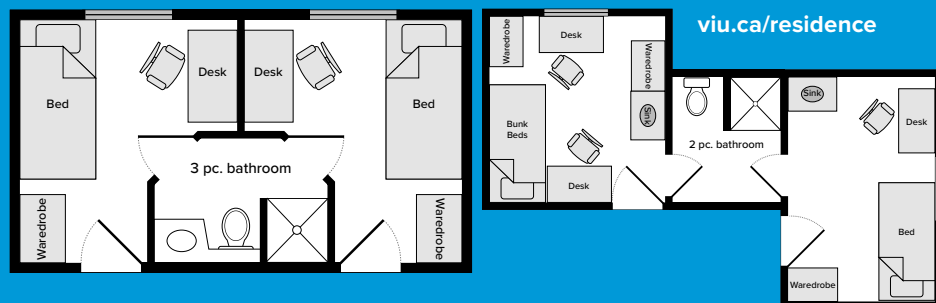

A homestay Canadian  
family experience



# How to apply

## Step 1

**Choose Your Program:** [viu.ca/programs/graduate-programs](https://viu.ca/programs/graduate-programs).

Check entrance requirements, and gather the required documents to scan and upload with your application.

Documents required:

- Official academic transcripts,
- Any other supporting documents (resume, statement of intent, etc.),
- Official translations of any documents being submitted that are in a language other than English,
- A copy of your passport (photo page), and
- VIU approved English proficiency test certificate  
[international.viu.ca/admissions#graduateadmissions](https://international.viu.ca/admissions#graduateadmissions)

## Step 2

**Apply Online:** [world.viu.ca/apply](https://world.viu.ca/apply).

Upload scanned copies of all required documents (in separate PDF files), and pay the non-refundable application fee of \$150 CAD.

NOTE: Due to limited space in certain programs, qualified applications received by the application deadline do not guarantee that an offer will be made. Early applications are encouraged.

## Step 3

**Receive your Letter of Offer.**

If successful, this will be within 4-6 weeks after application from [masters@viu.ca](mailto:masters@viu.ca).

Note program start dates and payment information.

## Step 4

**Accept your Offer + Pay your Tuition Deposit.**

This is typically due 4 weeks after receiving the Offer Letter: [viu.ca/admissions/how-do-i-pay](https://viu.ca/admissions/how-do-i-pay). Return signed policy documents.

Courier or mail your original or certified copies of your academic transcripts to: International Admissions  
Vancouver Island University  
900 Fifth Street Nanaimo, BC, V9R 5S5 Canada

## Step 5

**Receive Letter Of Acceptance from [masters@viu.ca](mailto:masters@viu.ca).**

## Step 6

**Apply For Your Study Permit from the nearest Canadian Embassy, Consulate, or High Commission.**

## Typical one-year budget

 **\$15,505**  
Living Costs  
Shared off-campus  
housing & food

 **\$1,200**  
Books

 **\$2,100**  
Student fees +  
medical insurance

 **\$600**  
Transportation  
(Bus)

 **\$3,000**  
Miscellaneous

*This budget does not include tuition fees and is based on 2 semesters of study and one semester off.*

For a cost of living estimate, please visit <https://international.viu.ca/cost-calculator>

**NOTE:** To obtain a study permit, you need to show that you have enough money to pay for your tuition and living expenses for at least one year, as well as for return transportation to your home country. Visit Immigration, Refugees, and Citizenship Canada's website at [cic.gc.ca](https://cic.gc.ca) for the most up-to-date study permit information.





## VANCOUVER ISLAND UNIVERSITY

### Contact us

International Education  
Vancouver Island University  
900 Fifth Street  
Nanaimo, BC  
Canada, V9R 5S5

Phone: 1.250.740.6315  
Canada/USA Toll-free:  
1.888.920.2221  
Email: [Worldviu@viu.ca](mailto:Worldviu@viu.ca)

**world.viu.ca**

### For inquiries for the following regions:

#### Africa

[Africa@viu.ca](mailto:Africa@viu.ca)

#### Canada/USA:

[worldviu@viu.ca](mailto:worldviu@viu.ca)

#### China:

[China@viu.ca](mailto:China@viu.ca)

#### CIS/Middle East:

Mikhail Ivanov  
[Mikhail.Ivanov@viu.ca](mailto:Mikhail.Ivanov@viu.ca)

#### India/Bangladesh/Nepal Sri Lanka/Pakistan:

[SouthAsia@viu.ca](mailto:SouthAsia@viu.ca)

#### ASEAN:

[ASEAN@viu.ca](mailto:ASEAN@viu.ca)

#### Japan:

[Japan@viu.ca](mailto:Japan@viu.ca)

#### Latin America:

[LatinAmerica@viu.ca](mailto:LatinAmerica@viu.ca)

#### Western Europe:

[Europe@viu.ca](mailto:Europe@viu.ca)

#### The High School:

[highschool@viu.ca](mailto:highschool@viu.ca)

#### ESL Inquiries:

[worldviu@viu.ca](mailto:worldviu@viu.ca)

#### International University Foundation Year:

[unipath@viu.ca](mailto:unipath@viu.ca)

#### For all other inquiries:

[worldviu@viu.ca](mailto:worldviu@viu.ca)



facebook /**WorldVIU**



twitter @**WorldVIU**



instagram @**WorldVIU**



youtube @**WorldVIU**



weibo 温哥华岛大学



wechat @**HelloVIU**  
@**StudyatVIU**

The Vancouver Island University community acknowledges and thanks the Snuneymuxw, Snaw-Naw-As, Quw'utsun and Tla'amin peoples, on whose traditional lands we teach, learn, research, live and share knowledge.

## Getting to campus



### Airplane

20 minute flight from Vancouver



### BC Ferries

There are two car/passenger ferry routes linking Vancouver to Nanaimo

**Horseshoe Bay to Departure Bay** (1.5 hours)

**Tsawwassen to Duke Point** (2 hours)



### Float plane

There are two float plane companies that link Vancouver to Nanaimo

**Harbour Air** (20 minutes)

**Sea Air** (20 minutes)

